

## CHIMNEY LINERS INSTALLATION MANUAL

1.

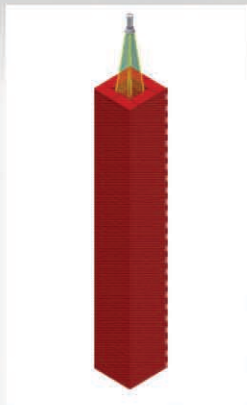

Before starting the liner installation, check the state and patency of the chimney. If irregular obstacles or excessive mortar occur, they should be eliminated.

2.

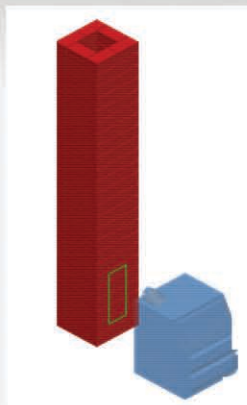

Mark and cut an opening for inspection unit and connection tee. The opening should consider the easiest possible way to connect the stove output

3.

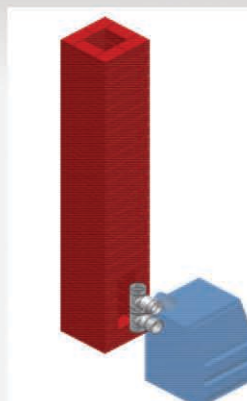

Place inspection unit and connection tee in the cut opening.

4.

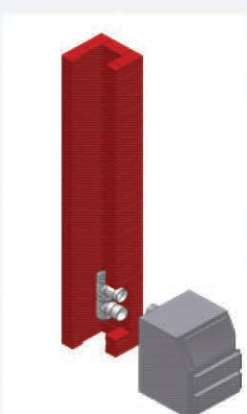

Ideally, that the vertical axis of the tee is in the middle of the chimney shaft, and the inspection and connection branches stand out of the chimney wall.

5.

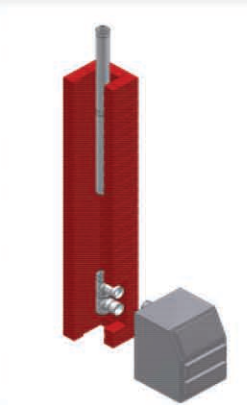

After mounting the inspection unit and the connection tee, start mounting straight pipes. The pipes should be slid down from the top of the chimney using a rope.

6.

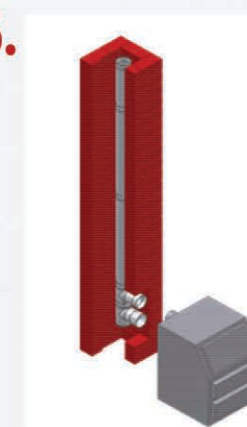

The last pipe should stand out above the chimney edge, to enable installation of the roof cover and rain cap

7.

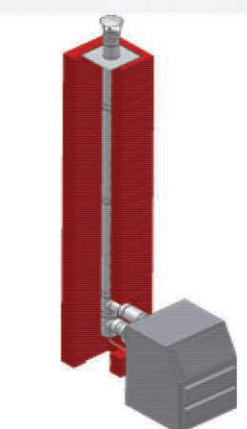

After placing all the pipes, mount a condensate hose, roof cover, rain cap and inspection locking plug.

8.

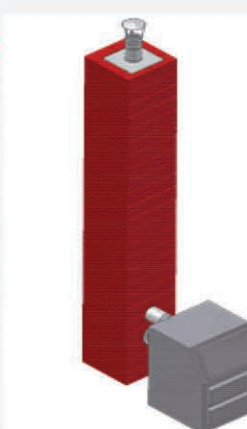

After installation of the liner, wall up the opening for placing the inspection unit and connection tee. Connect the stove gas output to the liner and do the initial start-up of the stove.